

STUDIO

SHU TO ✓

STUDIO



SHU TO /

STUDIO

SHU TO /

STUDIO BY CREATIVE STUDIO

FOR PRESS ROOM, MEETING ROOM, EXHIBITION, AND PHOTO SHOOTING

SHU TO / is a creative studio which explores spatial self-expression. This studio designed by SHU TO / is located in a quiet and verdant area of Omotesando.

It is characterized by the contrast between wood and steel, and a comfortable atmosphere like being outside even in the room with special finishes on the floor and walls which express outside. It is equipped with aluminum fixtures for hanger racks, picture hangers, shelves, and desks, as well as monitors, mirrors, tables, chairs, and a kitchen.

- ※ Not accept to hold an event with large numbers of visitors
- ※ Parking available on site

プレスルーム、商談、アパレル・雑貨・アート展示、撮影に

SHU TO / は空間的自己表現を思考する、空間のデザインとアートを手掛けるクリエイティブスタジオ。その SHU TO / が設計、運営する本スタジオは、表参道の閑静で緑豊かなエリアに位置し、木と鉄のコントラストと、特殊な床・壁面の仕上げによる“外”を感じさせる心地の良さが特徴。

ハンガーラック、絵画掛け、展示棚、デスク用途の什器、及びモニター、ミラー、テーブル、椅子、キッチン完備。

- ※ 大人数のイベントはお断りしています
- ※ 敷地内 時間貸駐車場有



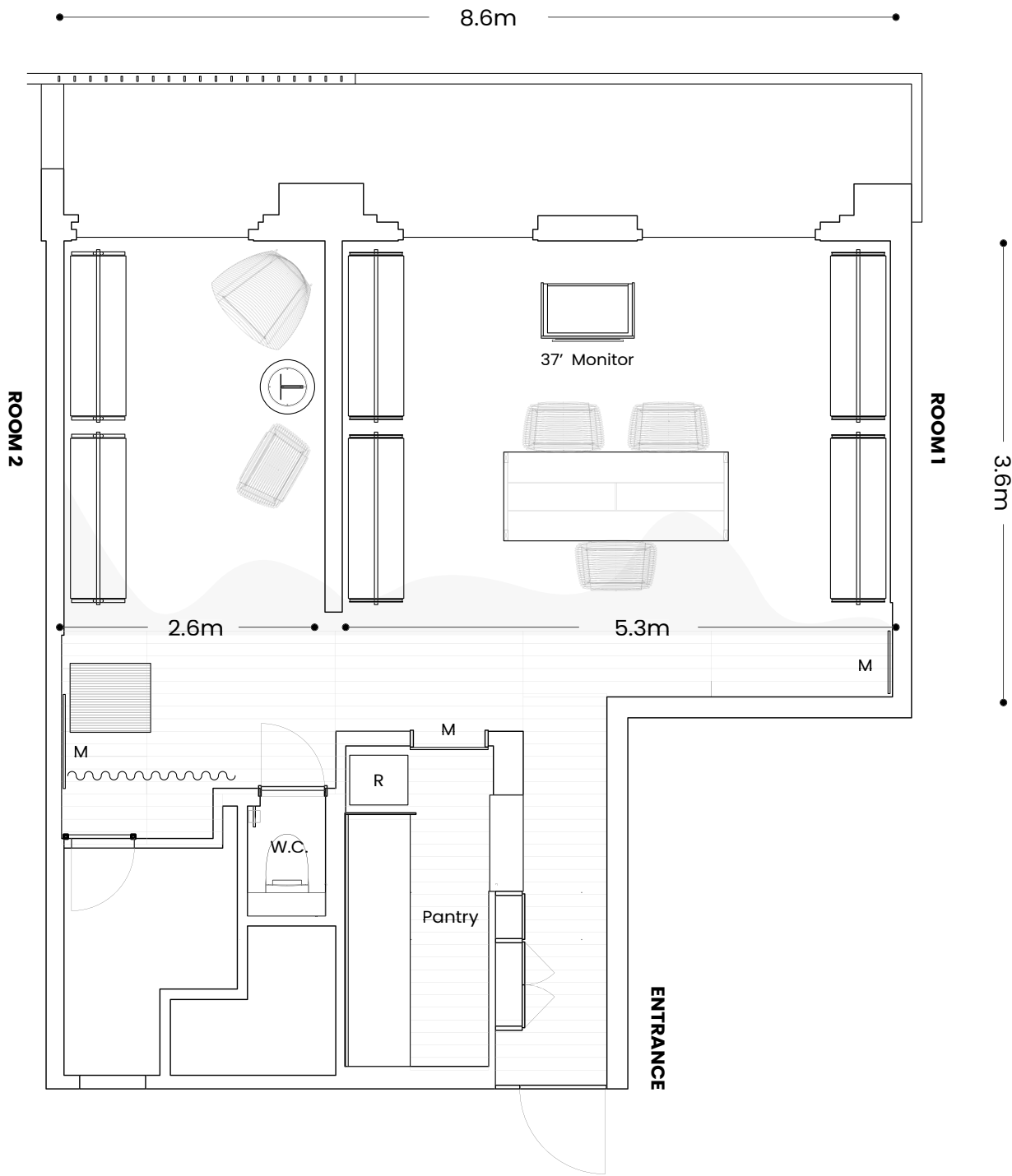

LAY OUT

53.9 m² Hight 2.45m

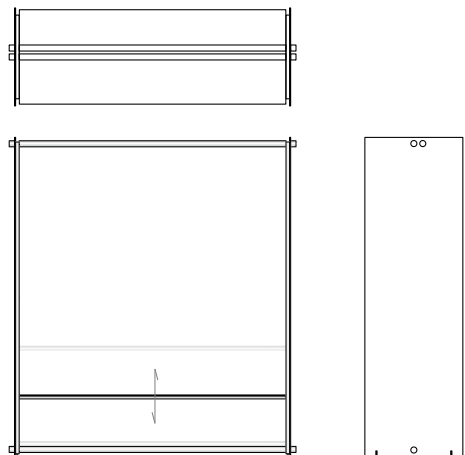

ALUMINUM RACK
165 180 53 (cm)

×6

Usage
Hunger rack / Table / Desk

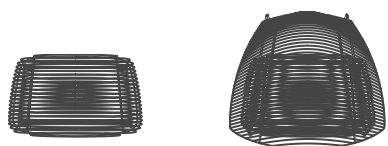

LOUNGE CHAIR / STOOL

×4 / ×1

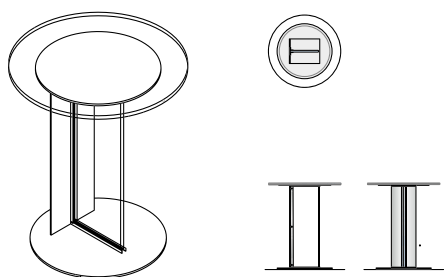

GLASS LEG TABLE
53 53 62 (cm)

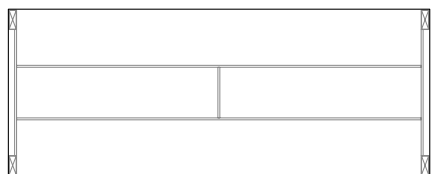

GLASS TOP TABLE
215 85 (cm)

M

MIRROR

×3



MONITOR 37"



SHU TO /



SHU TO /



SHU TO /



SHU TO /





SHU TO /



SHU TO /



SHU TO /



SHU TO /

SHU TO /

朱都

シュット

SHU TO /

LOCATION



Address 711, 6-1-32, Minami-Aoyama, Minato-ku, Tokyo, JAPAN 107-0062

E-mail contact@shu-to.jp

107-0062 東京都港区南青山 6-1-32 #711 表参道駅 A5出口から徒歩約5分

SHU TO /

711, 6-1-32, Minami-Aoyama, Minato-ku,
Tokyo, JAPAN 107-0062
contact@shu-to.jp